

RoHS Compliant

A

B

C

D

E

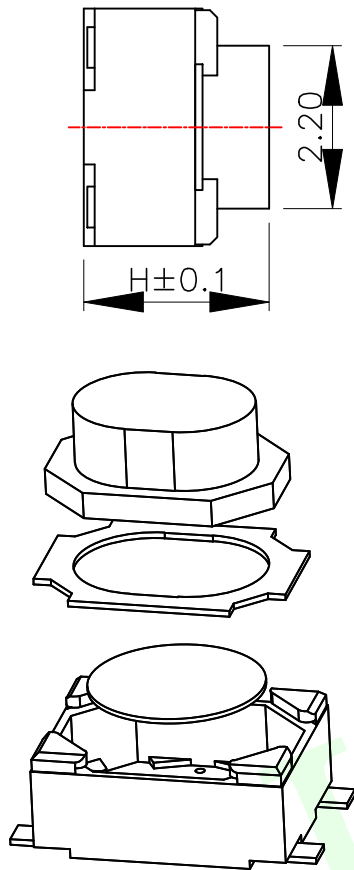

### 主要技术规格:

1. 额定值: 50mA DC12V
2. 接触电阻:  $\leq 100\text{m}\Omega$
3. 操作力:  $250 \pm 40\text{gf}$
4. 行程:  $0.20 \pm 0.05\text{mm}$
5. 绝缘电阻:  $\geq 100\text{M}\Omega$
6. 抗电强度: 250V 50HZ 1Min.
7. 寿命: 100,000 Cycles

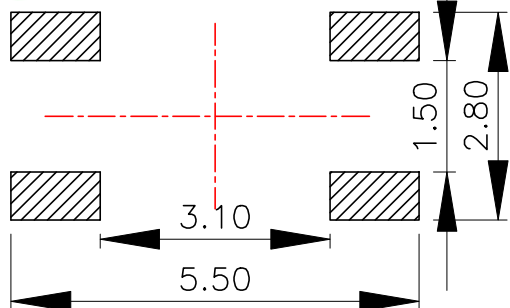
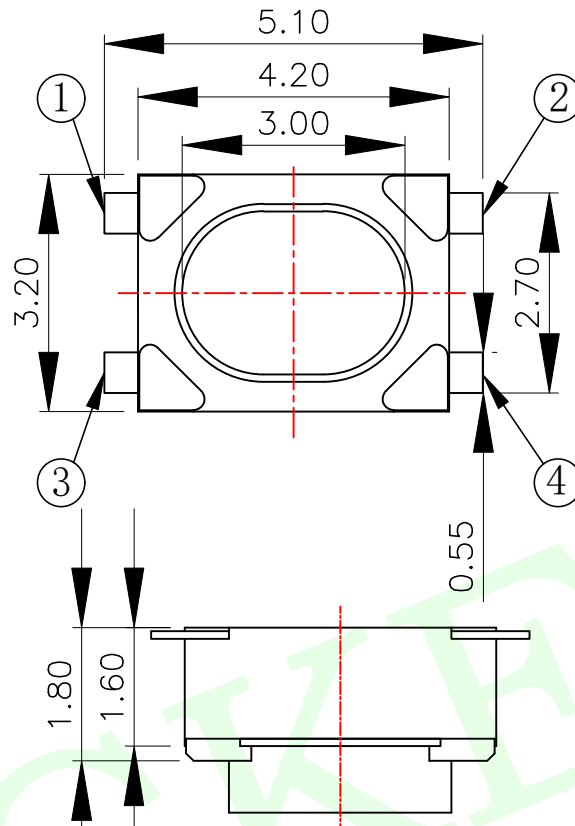

PCB. 焊接图

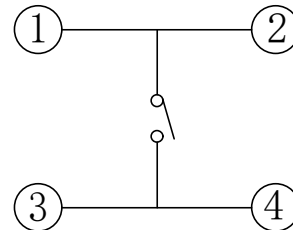

电路图

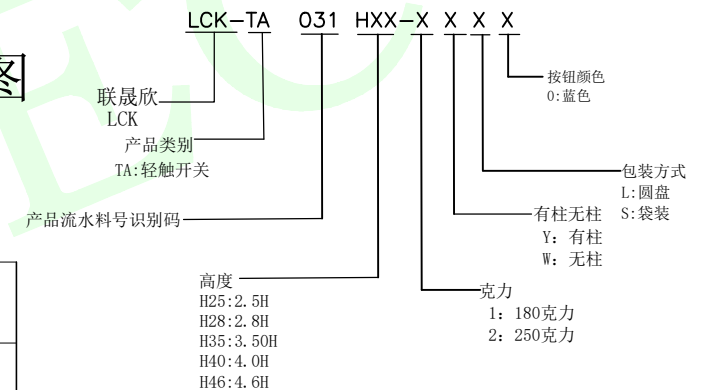
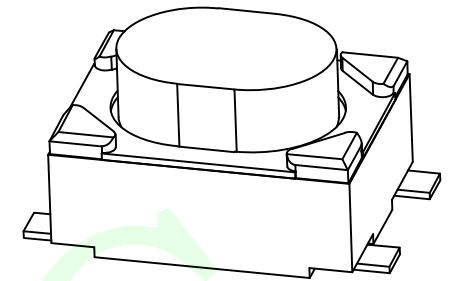

H
2.5
2.8
3.5
4.0
4.6

序号	部件名称	材料	数量	备注
1	基座	LCP	1	耐温280℃
2	嵌件	黄铜	1	镀银
3	簧片	不锈钢	1	覆银
4	按钮	PPA&硅胶	1	耐温280℃
5	盖板	黄铜	1	镀锡

QUADRANT POINT (QP)  
TANGENCY POINT (TP)  
INTERSECTION POINT (IP)

UNLESS OTHERWISE SPECIFIED, TOLERANCE:  
X. ±0.25  
X.x ±0.20  
X.xx ±0.15  
ANGULAR ±3°

联晟欣连接器 (深圳) 有限公司  
Lianshengxin Connector (Shenzhen) Co., Ltd

DESIGN	Andy	DATE	2014.12.24	TITLE:  TACRILE SWITCH			
CHECKED		DATE					
APPROVED		DATE					
PART NO: LCK-TA031HXXX-XXX				REV: 04	SCALE: 1:1	UNIT: mm	
DRAWING NO:				SIZE: A4	SHEET: 1/1	