

RoHS Compliant

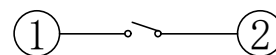

电路图

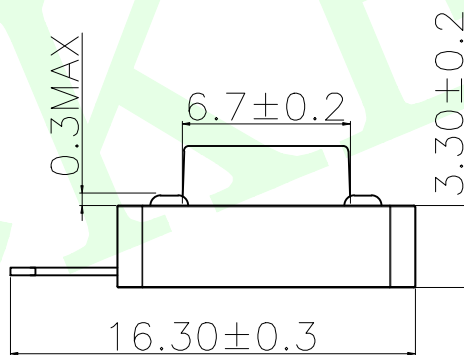
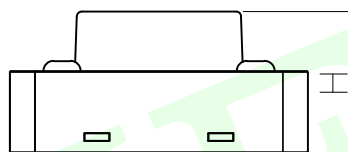
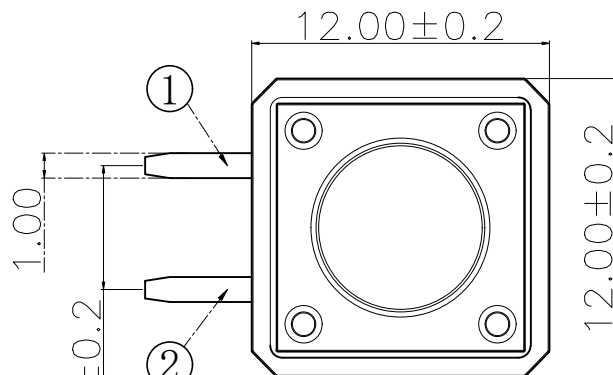
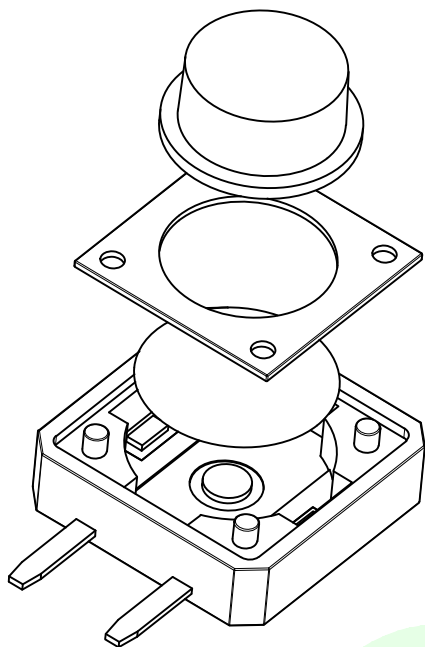
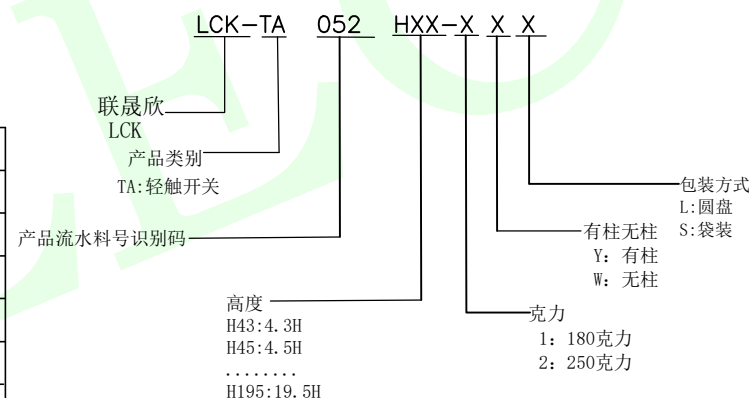
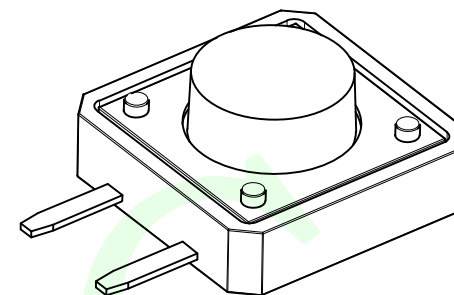

H	
4.3	4.5
5.0	5.5
6.0	6.5
.....
18.0	18.5
19.0	19.5

5	引脚、触点	黄铜	1	镀银
4	基座	PPA	1	耐温280℃（黑色）
3	簧片	不锈钢	1	覆银
2	盖板	冷轧钢	1	镀锡
1	按钮	PPA	1	耐温280° C（黑）
序号	零件名称	材料规格	数量	备注

QUADRANT POINT
TANGENCY POINT
INTERSECTION POINT

QPI
TP
IP



联晟欣连接器（深圳）有限公司
Lianshengxin Connector (Shenzhen) Co., Ltd

UNLESS OTHERWISE
SPECIFIED, TOLERANCE:

X. ±0.25
X.x ±0.20
X.xx ±0.15
ANGULAR ±3°

DESIGN Andy DATE 2014.12.24
CHECKED DATE
APPROVED DATE
PART NO: LCK-TA052HXXX-XXXX
DRAWING NO:

TITLE: TACRILE SWITCH
REV: 04 SCALE: 1:1 UNIT: mm
SIZE: A4 SHEET: 1/1

主要技术规格:

- 额定值: 50mA DC12V
- 接触电阻: $\leq 50m\Omega$
- 操作力: $250 \pm 40gf$
- 行程: $0.35 \pm 0.1mm$
- 绝缘电阻: $\geq 100M\Omega$
- 抗电强度: 250V 50HZ 1Min.
- 寿命: 100,000 Cycles

PCB. 焊接图

